

## Building Sketch

Borrower				
Property Address 3804 Aspenwood Dr				
City	Bedford	County	Tarrant	State TX Zip Code 76021
Lender/Client				

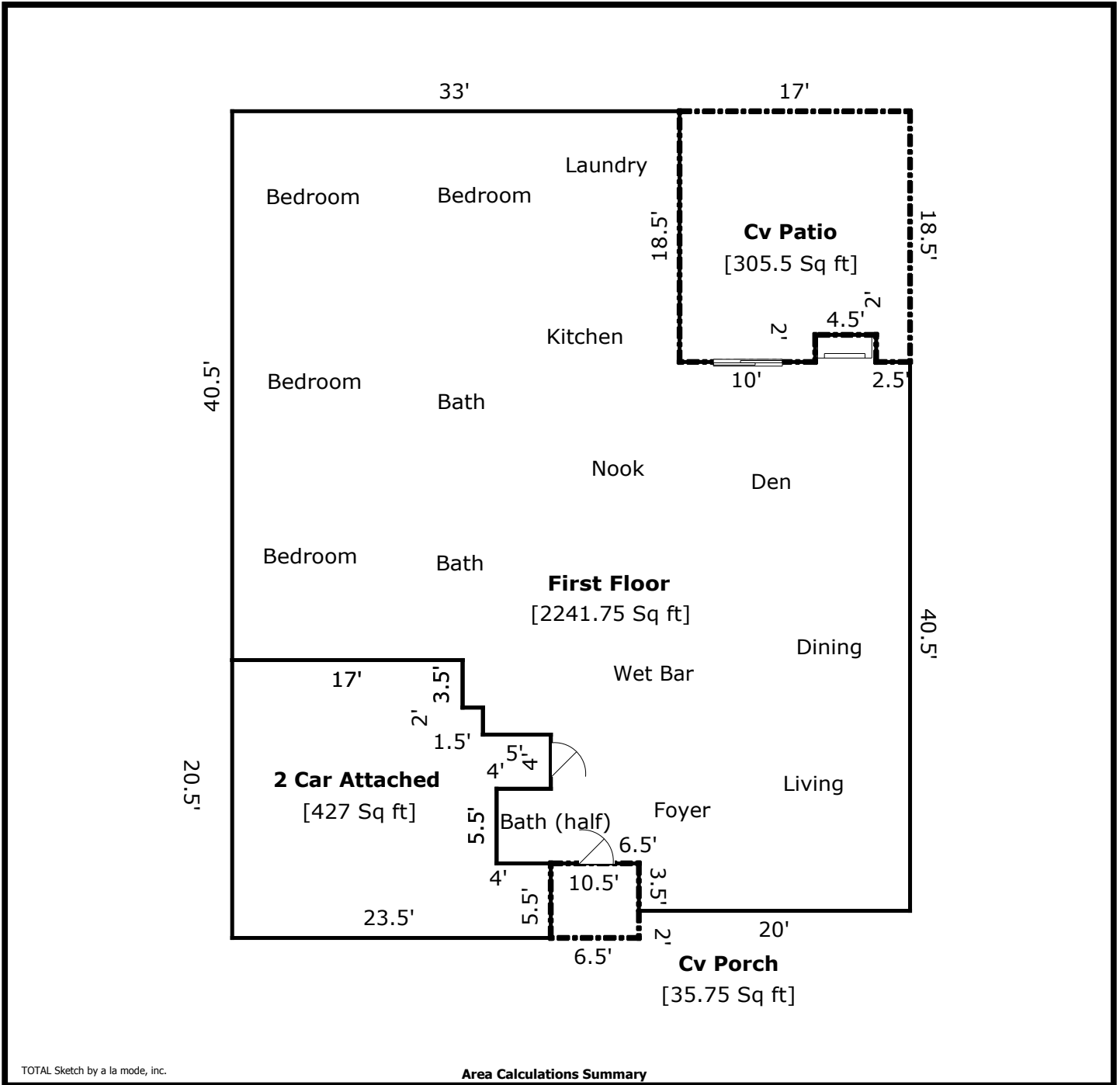

### Area Calculations Summary

Living Area	Area	Calculation Details
First Floor	2241.75 Sq ft	$4.5 \times 2 = 9$ $33 \times 18.5 = 610.5$ $22 \times 17 = 374$ $33 \times 25.5 = 841.5$ $15 \times 20 = 300$ $11.5 \times 6.5 = 74.75$ $4 \times 5.5 = 22$ $5 \times 2 = 10$
<b>Total Living Area (Rounded):</b>	<b>2242 Sq ft</b>	
Non-living Area	Area	Calculation Details
Cv Porch	35.75 Sq ft	$6.5 \times 5.5 = 35.75$
2 Car Attached	427 Sq ft	$4 \times 4 = 16$ $20.5 \times 17 = 348.5$ $6.5 \times 5.5 = 35.75$ $1.5 \times 2 = 3$ $2.5 \times 9.5 = 23.75$
Cv Patio	305.5 Sq ft	$17 \times 16.5 = 280.5$ $2 \times 2.5 = 5$ $2 \times 10 = 20$